

TODD TUCKER, CPED
Professional Member
American Institute of Building Design
Institute of Classical Architecture
2781 County Line Road
St. Pauls, NC 28384
(910) 322-5912



TODD TUCKER 04-108

THE INFORMATION ON THESE CONSTRUCTION DOCUMENTS IS THE SOLE PROPERTY OF THE ARCHITECT AND IS TO BE USED ONLY FOR THE PROJECT AND SITE SPECIFICALLY IDENTIFIED HEREIN. ANY REUSE OR MODIFICATION OF THESE DOCUMENTS WITHOUT THE WRITTEN CONSENT OF THE ARCHITECT IS PROHIBITED. THE ARCHITECT ASSUMES NO LIABILITY FOR ANY DAMAGE OR INJURY TO PERSONS OR PROPERTY ARISING FROM THE USE OF THESE DOCUMENTS. THE ARCHITECT'S RESPONSIBILITY IS LIMITED TO THE DESIGN AND CONSTRUCTION OF THE PROJECT AS SHOWN ON THESE DOCUMENTS. THE ARCHITECT DOES NOT WARRANT THE ACCURACY OF ANY INFORMATION PROVIDED BY OTHERS TO THE ARCHITECT OR THE ARCHITECT'S LIABILITY TO ANY OTHER PARTY IS LIMITED TO THE EXTENT OF THE ARCHITECT'S NEGLIGENCE OR WILLFUL MISFEASANCE.

Caviness & Cates

SHEET TITLE: **SECOND FLOOR PLAN**

1/4" = 1'-0"

JANUARY 2009

CG 2062 NOLAN DELUXE

A-5

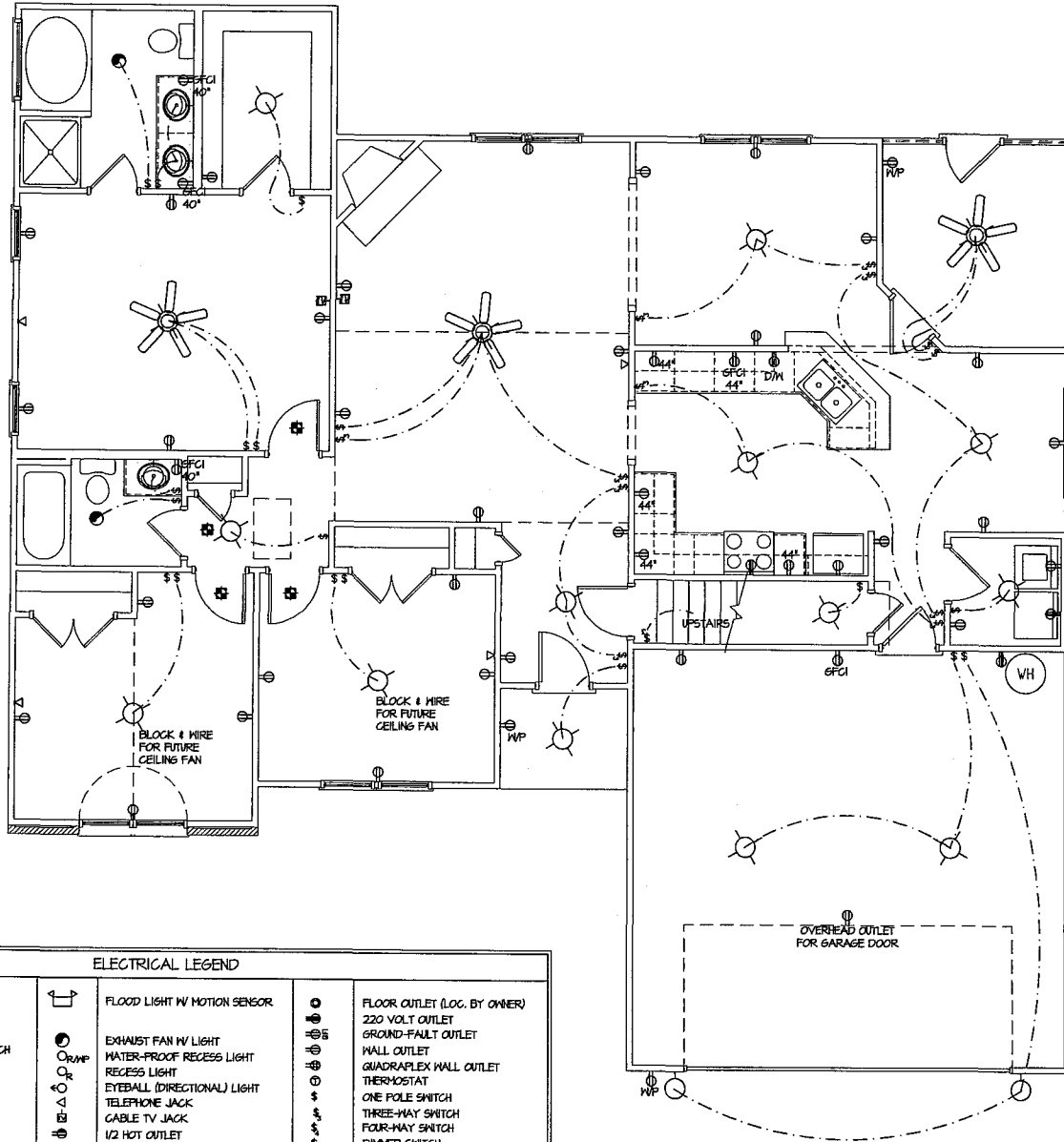

ELECTRICAL LEGEND

	CEILING FAN w/ LIGHT		FLOOD LIGHT w/ MOTION SENSOR		FLOOR OUTLET (LOC. BY OWNER)
	CEILING FAN ON DIMMER SWITCH		EXHAUST FAN w/ LIGHT		220 VOLT OUTLET
	CEILING-MOUNTED FLUORESCENT LIGHT		WATER-PROOF RECESS LIGHT		GROUND-FAULT OUTLET
	CEILING-MOUNTED LIGHT		RECESS LIGHT		WALL OUTLET
	HALL-MOUNTED LIGHT		EYEBALL (DIRECTIONAL) LIGHT		QUADRAPLEX WALL OUTLET
	UL-APPROVED SMOKE DETECTOR		THERMOSTAT		ONE POLE SWITCH
			TELEPHONE JACK		THREE-WAY SWITCH
			CABLE TV JACK		FOUR-WAY SWITCH
			1/2 HOT OUTLET		DIMMER SWITCH
			WATER-PROOF OUTLET		WATER-PROOF SWITCH
			OUTLET MOUNTED XX" A.F.F.		GROUND-FAULT SWITCH



TODD TUCKER, CPBD
Professional Member
American Institute of Building Design
Institute of Classical Architecture
2761 County Line Road
St. Pauls, NC 28384
(910) 322-5972



TODD TUCKER 34-188

THE INFORMATION IN THIS CONTRACT DOCUMENT IS TO BE OBTAINED OUT OF THE PLAN IN CONNECTION WITH THE WORK REQUIRED BY THE CONTRACTOR. THE CONTRACTOR SHALL BE RESPONSIBLE FOR OBTAINING ALL NECESSARY PERMITS AND FOR OBTAINING ALL NECESSARY INFORMATION FROM THE ARCHITECT AND THE CLIENT. THE CONTRACTOR SHALL BE RESPONSIBLE FOR OBTAINING ALL NECESSARY INFORMATION FROM THE ARCHITECT AND THE CLIENT. THE CONTRACTOR SHALL BE RESPONSIBLE FOR OBTAINING ALL NECESSARY INFORMATION FROM THE ARCHITECT AND THE CLIENT.

Caviness & Cates
ELECTRICAL PLAN
SHEET TITLE:

1/4" = 1'-0"

JANUARY 2009

CC 2062 NOLAN DELUXE

E-1

